

INTO 

MANCHESTER

IN PARTNERSHIP WITH THE UNIVERSITY OF MANCHESTER

MANCHESTER
1824

The University of Manchester

**RUSSELL
GROUP**

UNIVERSITY OF MANCHESTER

INTO UNIVERSITY PATHWAYS

FOR INTERNATIONAL STUDENTS

2020–21

LEARN WITHOUT BOUNDARIES

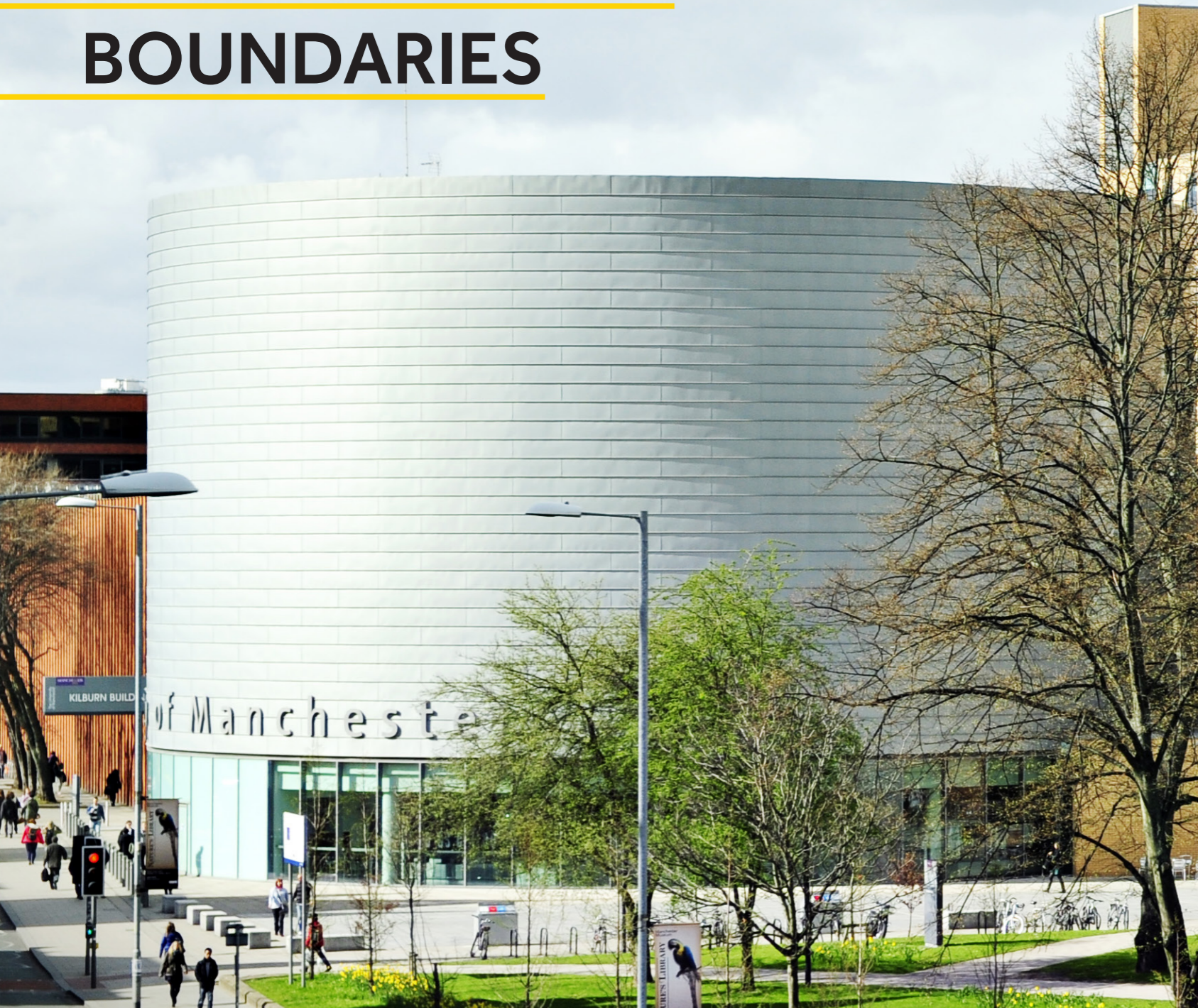

27th

in the world and 6th in the UK

(QS World University Rankings 2020)

No.1

targeted university by top employers in the UK

(High Fliers Research 2019)

25

Nobel Prize winners have studied or worked at The University of Manchester

Welcome to INTO Manchester, your pathway to an internationally-recognised degree from The University of Manchester. We give international students like you the opportunity to study at a historic and highly-ranked university.

At INTO Manchester, you'll study a specialist programme designed exclusively for international students and tailored to the requirements of the University. We'll help you improve your English language skills and adjust to life as a student in the UK so when you successfully complete your pathway, and meet the required grades, you can confidently progress to your degree at The University of Manchester.

You'll complete your course at our modern INTO Study Centre in the student-friendly city of Manchester – and with access to many key facilities on campus, you'll soon be ready to join The University of Manchester.

Choosing to study abroad is a big decision, but at INTO Manchester, we'll give you everything you need to succeed at university and beyond.

Choose #INTOManchester and open up a lifetime of opportunities.



THE UNIVERSITY OF MANCHESTER'S GLOBALLY-RANKED SUBJECT AREAS

11th

Pharmacy and Pharmacology

21st

Accounting and Finance

21st

Chemical Engineering

23rd

Sociology

32nd

Chemistry

32nd

Materials Science

35th

Business and Management

35th

Law

38th

Electrical and Electronic Engineering

(Times Higher Education World University Rankings by Subject 2019)

ABOUT THE UNIVERSITY



Successfully complete your pathway at INTO Manchester, and meet your progression requirements, to study at The University of Manchester – one of the top universities in the world. Study here and you'll be part of one of the UK's biggest student communities, making use of world-class, modern facilities housed among historic Victorian buildings.

Educational excellence

Prepare to study at one of the most respected institutions in the world. The University of Manchester is recognised for its high-quality education, research and academic achievements dating back more than 190 years.

This prestigious University is consistently rated in the top 30 in the world rankings and is currently ranked 27th in the world*.

Encouraging innovation

From the birth of the modern computer to the isolation of graphene, world-changing innovation is at the heart of the University. This elite Russell Group university is ranked 5th in the UK for 'research power'**.

Research covers one of the largest ranges of academic areas amongst UK universities. During your degree you may:

- be taught by staff with strong links to industry
- have the chance to undertake work experience
- contribute to research and studies in your subject area
- develop skills and knowledge that will boost employability.

Join a community of pioneers

Many of the 480,000 alumni have top positions in business, politics, industry and the arts across more than 190 countries around the world. With such a high calibre of real-world learning and an international focus, it's no wonder that 25 Nobel Prize winners have studied or worked at The University of Manchester throughout its impressive history.

Create your future

The University of Manchester also gives you the opportunity to boost your employability skills and set you up for future success. You can develop career-focused skills through:

- 'Stellify', the University's unique extracurricular scheme which involves volunteering, activities and career development opportunities
- the Manchester Leadership Programme
- the University's comprehensive Careers Service.

These services help The University of Manchester produce some of the most employable graduates around the world and you'll soon discover why it's the number one targeted university by top employers in the UK†.

* QS World University Rankings 2020
** Research Excellence Framework 2014
† High Fliers Research 2019

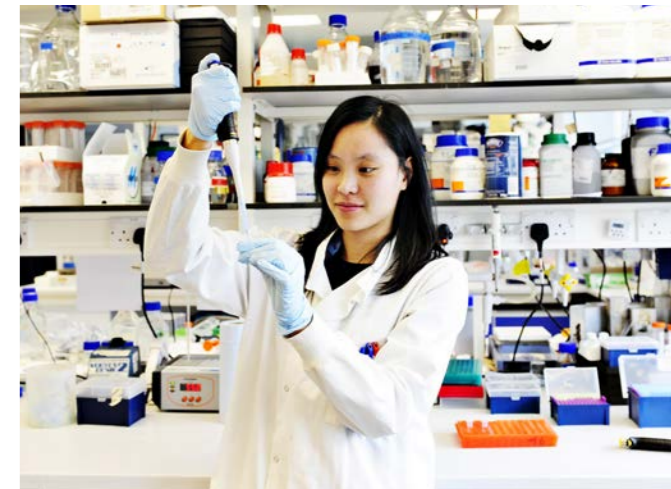

"Successful completion of the INTO Manchester International Foundation can lead to a wide range of undergraduate courses here at The University of Manchester. This includes various courses in Business and Management, Law, Science, Engineering, Biosciences, Pharmacy and Psychology. I look forward to welcoming you here in the future."

Fiona Brown,
Head of International Recruitment,
The University of Manchester

UNIVERSITY FACILITIES

Whatever you choose to study at The University of Manchester, following your pathway at INTO Manchester, you'll benefit from a recent £1.75 billion investment in cutting-edge facilities and equipment – one of the biggest investments ever seen at a university in the UK.

Inspiring learning spaces

You'll have access to some excellent facilities as a **student at The University of Manchester**.

- **Alliance Manchester Business School** – home to the Behavioural Research Laboratory.
- **Manchester Engineering Campus Development** – the brand new Engineering building, the MECD will be the single largest home for Engineering in the UK when it opens in 2021.
- **Specialist facilities** – include a moot court (School of Law), MRI scanners (Faculty of Biology, Medicine and Health), a chemical manufacturing laboratory (Faculty of Science and Engineering) and much more.

Staying healthy

Students are entitled to discounted rates at the University's sports facilities, which includes three fitness suites, two 50-metre swimming pools and many indoor courts and outdoor pitches close to campus.

The Athletic Union is made up of more than 40 sports clubs so you also have the chance to represent the University. Other organised activities include campus sports leagues, hall sport sessions and health and fitness classes.

The city offers even more facilities, with Sportcity which includes an indoor tennis centre and an athletics centre and Manchester Velodrome. There's also Chill Factor indoor ski slope. All of this is just a short distance away.

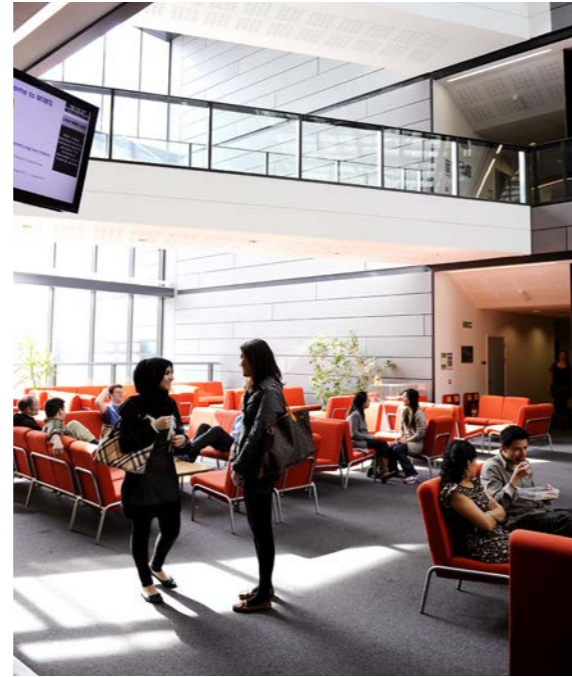

Here are some of the facilities you'll have access to as an **INTO Manchester student**:



Science labs
(if you're on a science or engineering pathway)



Armitage and Sugden Sports Centres
(student discount available)



Manchester Aquatics Centre
(student discount available)



Main Library – one of the best-resourced academic libraries in the UK



DISCOVER MANCHESTER

A diverse mix of music, shopping, sport and a buzzing social scene all wrapped up in one student-focused city. Get ready to explore the UK's capital of the North and one of the most exciting cities in the world.



Credit: Marketing Manchester

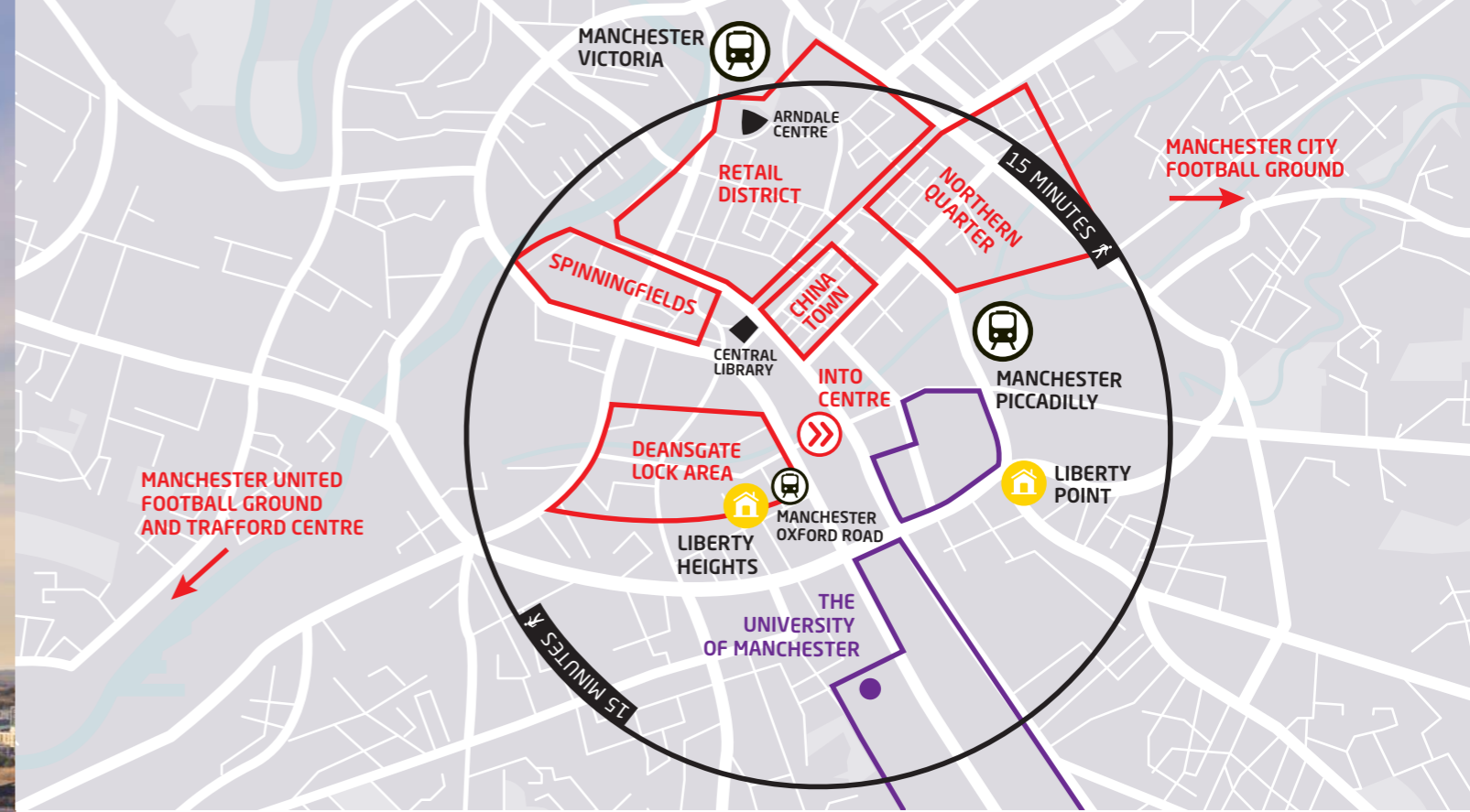

Top 10
most
exciting
city in
the world

(Time Out City Life Index 2018)



Credit: Marketing Manchester

Culture and creativity

When you live in Manchester, you'll be immersed in a lively world of music, art and fashion. You'll also have access to a bustling social calendar packed with festivals, all-day events, and free activities.

The city has over 30 museums and galleries, including:

- The Whitworth
- Manchester Museum
- Manchester Art Gallery
- Centre for Chinese Contemporary Art
- National Football Museum
- Museum of Science and Industry

The Portico, Chetham and Manchester Central Libraries are also a must-see in a city designated a **UNESCO City of Literature**.

Gourmet to everyday

With over 300 restaurants in the city, there's an exciting range of quality, modern British and international cuisine available, making it easy to find foods from around the world.

From fine dining in **Spinningfields** to street food at **Maker's Market**, you'll find options to suit your mood and budget. **Deansgate** offers everything from tapas to traditional British food while the cool cafés of the **Northern Quarter** are a favourite with locals.

Manchester's **Chinatown** is the second largest in Britain and has many Asian restaurants and supermarkets. There are also many restaurants and shops in **Rusholme**, offering South Asian and Middle Eastern cuisine and produce. You'll never run out of exciting options in Manchester!

An iconic sporting city

Manchester is home to two of the biggest names in sport: Manchester United and Manchester City. Manchester United's ground, **Old Trafford**, is the largest club ground in Britain, while Manchester City are based at the striking **Etihad Stadium**.

Fancy getting involved? The city offers a range of state-of-the-art facilities from indoor ski-slopes to velodromes. Sport is always at the heart of Manchester.

Getting out and about

Manchester is easy to get around on foot, by bus or by tram. It's also a great base to explore the UK and you can get to London in just two hours by train. **Manchester Airport** has flights to over 200 destinations including Europe, the US and Asia!

LIFE AT THE INTO CENTRE

Are you ready to live and learn in one of the UK's biggest and best student cities? With modern facilities in a historic building, an exciting programme of activities and a team of friendly staff, INTO Manchester has it all!

Your Study Centre

The INTO Manchester Centre offers you the chance to study in one of the most exciting and diverse cities in the world. Located in Bridgewater House, an impressive Edwardian era building, the Centre is right in the heart of bustling Manchester. Most of your classes will take place here, and you'll find everything you need to study and socialise in one location.

Our academic programmes here are taught in a similar way to what you'll experience at university so that you'll be ready when you progress. INTO Manchester's modern learning Centre includes:

- more than 40 teaching rooms featuring digital whiteboards
- well-equipped computing suites
- free Wi-Fi and internet access throughout
- 24/7 access to our virtual learning environment to download resources
- a Learning Resource Centre, with a wide range of online journals, books and excellent study materials
- silent study areas.

If you want a break between classes, relax in the break-out spaces where you can play table football with friends, or head out to the many cafés and shops on your doorstep. You'll soon feel right at home!

Supporting you

Studying in another country can be a big adjustment, and we're here to help you. Our friendly Student Services team will help take care of practicalities like accommodation, visa support and any questions about your course, so you can focus on your studies. You'll find our orientation programme in your first week invaluable, covering everything from opening a bank account to getting around the city – giving you all the information you need to help you settle in to your new life in Manchester.

Your safety is our priority

There's a 24-hour emergency telephone helpline if you need to speak to someone out of office hours. If you're under 18, we offer extra support that includes ensuring your safe transfer from the airport and checking on you each day at the residence where you'll live. You'll also be given a dedicated named person to contact to ensure your wellbeing and receive a copy of our code of conduct, which you must follow; especially outside of class when you'll be unsupervised. For more information, please see guidance for under 18s using the following link: www.intostudy.com/manchester/terms



"We can't wait to welcome you to the dynamic city of Manchester and help you settle into life in the UK. We have a team of experienced staff to help you with both academic matters and day-to-day living so you can concentrate on your studies and make the most of your time with us."

Dawn Abbott,
Centre Director

YOUR HOME FROM HOME

Liberty Point

Liberty Point is situated just 12 minutes' walk from the INTO Centre and close to The University of Manchester. Its central location means it's close to many restaurants, cafés and shops so there's plenty to see and do in the area.



- En suite bathroom
- Communal areas
- Laundry facilities
- Accepts under 18s
- 24/7 staff
- Wi-Fi

Liberty Point Premium

This accommodation option for INTO Manchester is just 12 minutes' walk from the INTO Centre, close to many shops, restaurants and cafés nearby.

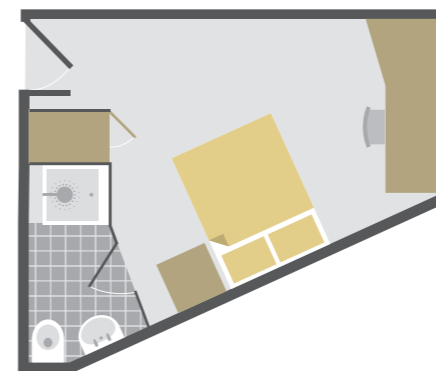

- En suite bathroom
- Communal areas
- Laundry facilities
- Accepts under 18s
- 24/7 staff
- Wi-Fi

Liberty Heights*

This studio accommodation option for INTO Manchester is located in the heart of Manchester, just 3 minutes' walk from the INTO Centre.

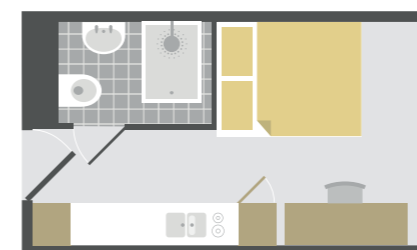

- En suite bathroom
- Communal areas
- Laundry facilities
- 24-hour gym
- 24/7 staff
- Wi-Fi

INTO Manchester aims to provide the accommodation requested. However, there may be occasions when INTO Manchester is unable to provide the requested accommodation and reserves the right to offer an alternative type of accommodation instead. The price for any alternative accommodation may differ and will be confirmed to students at the time of their offer.

* 18 years and over only

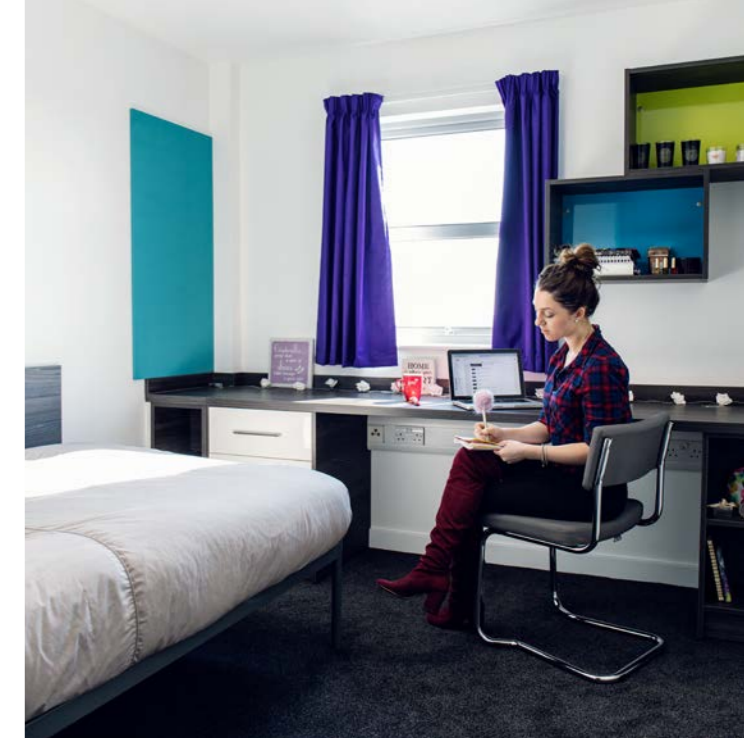

Supporting you

In all the residences, you'll find staff available 24/7 to offer support, and we'll also provide you with a 24-hour emergency helpline telephone number. If you're under 18 and living in INTO managed accommodation, we offer extra support and will check in on you each day at the student residence where you live.

Homestay

This is a unique opportunity to experience British life and culture first hand. You'll have a private room in a carefully selected host's home, sharing mealtimes and living spaces.

Choosing your course

Prepare for your university degree with our tailored, academic pathway programmes. You'll benefit from university-style teaching for subject-based modules and high academic standards. Then, when it comes to progressing to your chosen degree, we'll support you with your university application.

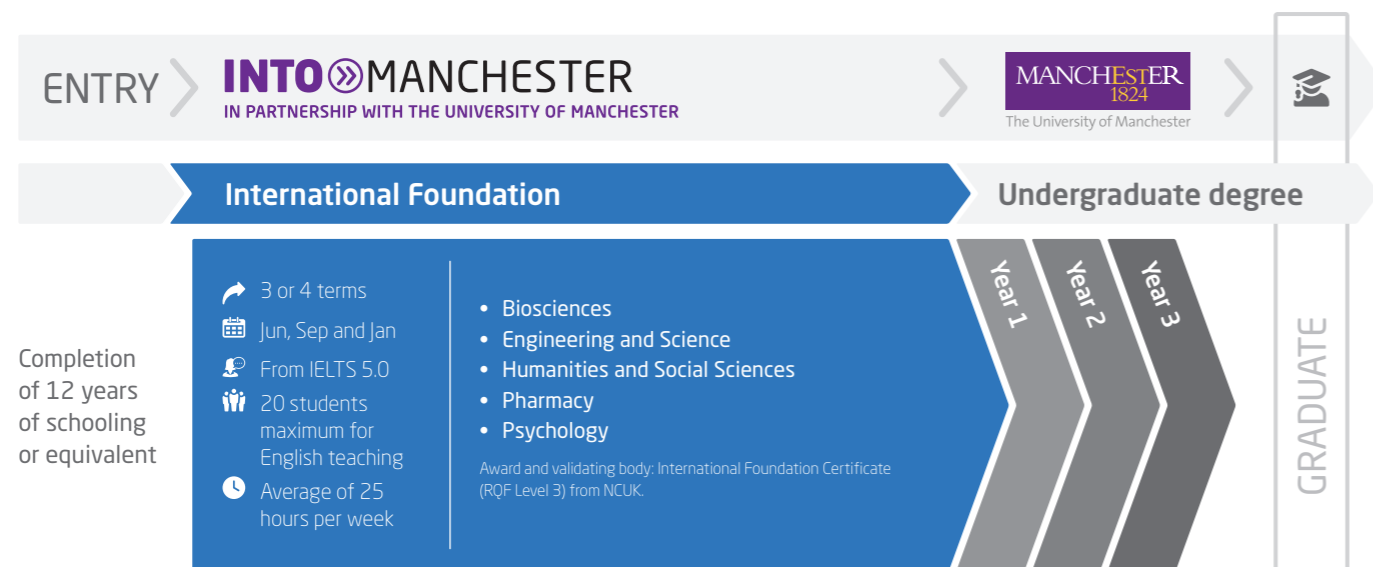

Please note that course length and start month options may vary depending on the pathway chosen. Please visit www.intostudy.com/manchester/courses for full information.



"INTO Manchester enabled me to experience entire independence, and learn self-control and time management."

Alina, Russia
Completed an International Foundation in Engineering and Science and progressed to BSc (Hons) Pharmacology at The University of Manchester



"The style and content of the course fit my expectations of what a good transition programme would be. The content of each subject and assignments given in class are a big help in developing the particular skills needed to succeed in university."

Tisya, Indonesia
Completed International Foundation in Humanities and Social Sciences and progressed to BSc (Hons) International Business, Finance and Economics at The University of Manchester

International Foundation

Biosciences - FB

- > Learn to write lab reports and understand scientific data.
- > Gain practical experience through laboratory work.
- > Specialist progression degrees include Genetics, Immunology, Neuroscience and Zoology.

What will I study?

Biology
Chemistry
Critical Thinking*
English for Academic Purposes and Study Skills
Information Communication Technologies (ICT)*
Mathematics

* Compulsory but non credit bearing

Progress to **1 of 20+** degrees. Find out more at www.intostudy.com/manchester/FB

Engineering and Science - FES

- > Visit the schools within the University faculty and gain an insight into the different degree programmes.
- > Gain practical experience through laboratory work.
- > Specialist progression degrees include Artificial Intelligence, Mechatronic Engineering and Physics with Astrophysics.

What will I study?

Critical Thinking*
English for Academic Purposes and Study Skills
Information Communication Technologies (ICT)*

3 out of 5**:

Biology
Chemistry
Further Mathematics
Mathematics
Physics

* Compulsory but non credit bearing

** Please note that the choice of subjects will depend on your chosen degree programme. Some subject combinations may not be available.

Progress to **1 of 50+** degrees. Find out more at www.intostudy.com/manchester/FES

Prepare to progress to a degree at The University of Manchester:

Top 40

in the world for
Materials Science

(QS World University Rankings by Subject 2019)

Top 40

in the world for
Mechanical Engineering

(QS World University Rankings by Subject 2019)

Top 40

in the world for
Chemistry

(QS World University Rankings by Subject 2019)

Top 40

in the world for
Electrical and Electronic Engineering

(QS World University Rankings by Subject 2019)

Progress to Year 1 of an undergraduate degree at The University of Manchester

Start date

3 term: Sep

English language entry requirements*

3 term: UKVI IELTS 6.0 (with a minimum of 6.0 in all subskills) or equivalent

Age requirement

16 years and above**

Note: progression to any degree from the Biosciences pathway is subject to interview.

Start date

3 term: Sep
4 term: Jun

English language entry requirements*

3 term: UKVI IELTS 5.5 (with a minimum of 5.5 in writing) or equivalent

4 term: UKVI IELTS 5.0 (with a minimum of 5.0 in writing and no less than 4.5 in any subskill) or equivalent

Age requirement

16 years and above**

* If you do not meet the minimum English language requirements you should apply for our Academic English course. See page 18 for more information.

** All students commencing courses on a published September start date must be 17 years old by 31 December of that calendar year. For all other start dates, students must be 17 years old on the published start date of the programme.

Progress to Year 1 of an undergraduate degree at The University of Manchester

Start date

3 term: Sep or Jan
4 term: Jun or Sep

English language entry requirements*

3 term: UKVI IELTS 5.5 (with a minimum of 5.5 in writing) or equivalent
4 term: UKVI IELTS 5.0 (with a minimum of 5.0 in writing) or equivalent

Age requirement

16 years and above**

* If you do not meet the minimum English language requirements you should apply for our Academic English course. See page 18 for more information.

** All students commencing courses on a published September start date must be 17 years old by 31 December of that calendar year. For all other start dates, students must be 17 years old on the published start date of the programme.

Prepare to progress to a degree at The University of Manchester:

Top 25

in the world for Sociology

(QS World University Rankings by Subject 2019)

Top 25

in the world for Accounting and Finance

(QS World University Rankings by Subject 2019)

Top 35

in the world for Business and Management

(QS World University Rankings by Subject 2019)

International Foundation

Humanities and Social Sciences - FHSS

- > Attend weekly drop-in sessions with a Link Tutor from the University.
- > Practise professional presentation skills through assessed group work.
- > Build confidence constructing academic arguments and learn how to write effective essays, and correctly research and reference academic sources.
- > Specialist progression degrees include Accounting and Finance, International Relations, and Management.

What will I study?

Critical Thinking*
English for Academic Purposes and Study Skills
Information Communication Technologies (ICT)*

3 out of 4:**

Business Studies
Economics
Mathematics
Government and Politics

* Compulsory but non credit bearing

** Please note that the choice of subjects will depend on your chosen degree programme. Some subject combinations may not be available.

Progress to **1 of 50+** degrees. Find out more at www.intostudy.com/manchester/FHSS

“The knowledge that I gained is really necessary for my university life. Through study with INTO Manchester, I found University much easier than other students who haven't completed a Foundation. Studying at INTO made me more confident in my English.”

Qinyu, China
Completed International Foundation in Humanities and Social Sciences and progressed to BSc (Hons) Economics at The University of Manchester



“A degree from The University of Manchester helped me with my application for my job, since my employers recognise the quality of education that the University provides.”

Abdulrahim, Oman
Completed International Foundation in Science and Engineering and graduated with BEng (Hons) Electrical and Electronic Engineering at The University of Manchester

International Foundation

Pharmacy - FPH

- > Gain practical experience through laboratory work.
- > MPharm Pharmacy degree is accredited by the General Pharmaceutical Council.
- > Gain real life experience on your degree in pharmacy departments and wards.

What will I study?

Chemistry
Critical Thinking*
English for Academic Purposes and Study Skills
Information Communication Technologies (ICT)*

3 out of 4:**

Biology
Further Mathematics
Mathematics
Physics

* Compulsory but non credit bearing

** Please note that the choice of subjects will depend on your chosen degree programme. Some subject combinations may not be available.

Progress to **MPharm Pharmacy**. Find out more at www.intostudy.com/manchester/FPH

Psychology - FPS

- > Investigate the study of sleep, nonverbal behaviour, eye movements and decision-making through lab work.
- > BSc (Hons) Psychology is accredited for membership of the British Psychological Society.

What will I study?

Critical Thinking*
English for Academic Purposes and Study Skills
Information Communication Technologies (ICT)*

3 out of 8:**

Biology	Further Mathematics
Business Management	Mathematics
Chemistry	Physics
Economics	Politics

* Compulsory but non credit bearing

** Please note that the choice of subjects will depend on your chosen degree programme. Some subject combinations may not be available.

Progress to **BSc Psychology**. Find out more at www.intostudy.com/manchester/FPS

Progress to Year 1 of an undergraduate degree at The University of Manchester

Start date

3 term: Sep

English language entry requirements*

UKVI IELTS 6.0 (with a minimum of 6.0 in all subskills) or equivalent

Age requirement

16 years and above**

Note: progression to any degree from the Pharmacy pathway is subject to interview.

Start date

3 term: Sep

English language entry requirements*

UKVI IELTS 5.5 (with a minimum of 5.5 in writing) or equivalent

Age requirement

16 years and above**

* If you do not meet the minimum English language requirements you should apply for our Academic English course. See page 18 for more information.

** All students commencing courses on a published September start date must be 17 years old by 31 December of that calendar year. For all other start dates, students must be 17 years old on the published start date of the programme.

Prepare to progress to a degree at The University of Manchester:

Top 15

in the world for Pharmacy and Pharmacology

(QS World University Rankings by Subject 2019)

Top 50

in the world for Psychology

(QS World University Rankings by Subject 2019)

Progression degree overview table

There are more than 100 progression degree options at The University of Manchester.

You can progress to any of these from one of our INTO Manchester pathway programmes.

Below is a selection of some of the most popular. See pages 12-15 for more details on the pathways.

100+
progression degree options

International Foundation progression

Degree	Pathway(s)	Specific requirements	English level	Final grade
Accounting BSc (Hons)	FHSS	Maths and any two from Politics, Economics and Business Studies	A with A in Speaking and Listening and no component below B	AAA
Accounting and Finance BA Econ (Hons)	FHSS	Economics and Maths	A with no component below B	AAB
Actuarial Science and Mathematics BSc (Hons)	FES	A* Maths, if taking Further Maths, grade A must be achieved	B with B in Writing and no component below C	A*AB
Aerospace Engineering BEng (Hons)*	FES	Maths and Physics	C	AAA
Architecture BA (Hons)	FHSS	Submission of a satisfactory portfolio	B	AAA
Artificial Intelligence BSc (Hons)*	FES or FB	Maths and Further Maths or Physics	B	A*A*A*
Biochemistry BSc (Hons)*	FB	A in two sciences: Chemistry, Biology, Physics, Maths. Chemistry is compulsory, Biology is preferred. Subject to successful interview	B with no component below B	AAB
Biology BSc (Hons)	FB	A in any two from Chemistry, Biology, Physics, Maths. Chemistry and Biology are preferred. Subject to successful interview	B with no component below B	AAB
Biotechnology BSc (Hons)*	FB	A in any two from Chemistry, Biology, Physics, Maths. Chemistry and Biology are preferred. Subject to successful interview	B with no component below B	AAB
Biomedical Sciences BSc (Hons)*	FB	A in any two from Chemistry, Biology, Physics, Maths. Chemistry and Biology are preferred. Subject to successful interview	B with no component below B	AAB
Cell Biology BSc (Hons)*	FB	A in any two from Chemistry, Biology, Physics, Maths. Chemistry and Biology are preferred. Subject to successful interview	B with no component below B	AAB
Chemical Engineering BEng (Hons)*	FES	Maths and Physics or Chemistry	B	AAA
Chemistry BSc (Hons)*	FES	Chemistry plus one from another science or mathematics. Evidence of Chemistry and Science background at Year 10/10th grade or higher, including Maths at GCSE grade 4/C or equivalent	C	A*AA
Civil and Structural Engineering MEng (Hons)	FES	Maths and Physics	C	AAA
Civil Engineering BEng* (Hons)	FES	Maths and Physics	C	AAA
Computer Science BSc (Hons)*	FES	A* in Maths and A in Further Maths or Physics	B	A*A*A*
Developmental Biology BSc (Hons)*	FB	A in any two from Chemistry, Biology, Physics, Maths. Chemistry and Biology are preferred. Subject to successful interview	B with no component below B	AAB
Earth and Planetary Sciences BSc (Hons)*	FES	At least one science subject	B with no component below B	AAB
Economics BSc (Hons)	FHSS	A in Maths and AB in Economics	A with no component below B	AAB
Economics and Finance BA Econ (Hons)	FHSS	Maths and Economics	A with no component below B	AAB
Economics and Politics BA Econ (Hons)	FHSS	Maths and Economics	B with Writing and Speaking grade B and Listening and Reading grade C	AAB
Electrical and Electronic Engineering BEng (Hons)*	FES	Maths and either Physics, Further Maths or Chemistry	B	AAB
Electronic Engineering BEng (Hons)*	FES	Maths and either Physics, Further Maths or Chemistry	B	AAB
Environmental Science BSc (Hons)*	FES	At least one science subject	B	ABB
Fashion Buying and Merchandising BSc (Hons)	FES or FHSS	None	C	AAB
Fashion Management BSc (Hons)	FES or FHSS	None	C	AAB
Fashion Marketing BSc (Hons)	FES or FHSS	None	C	AAB
Finance BA Econ (Hons)	FHSS	Maths and Economics	A with no component below B	AAB
Genetics BSc (Hons)*	FB	A in any two from Chemistry, Biology, Physics, Maths. Chemistry and Biology are preferred. Subject to successful interview	B with no component below B	AAB
Geography BA (Hons)	FES or FHSS	FHSS pathway: AAB, with C in high school Maths. International study available where AAA and C in high school Maths is required	B	AAB
Immunology BSc (Hons)*	FB	A in any two from Chemistry, Biology, Physics, Maths. Chemistry and Biology are preferred. Subject to successful interview	B with no component below B	AAB

Degree	Pathway(s)	Specific requirements	English level	Final grade
International Business, Finance and Economics BSc (Hons)	FHSS	Maths and any two from Politics, Economics and Business and Management	A with A in Speaking and Listening and no component below B	AAB
Law LLB (Hons)	FHSS	None	A	AAA
Life Sciences BSc (Hons)	FB	A in any two from Chemistry, Biology, Physics, Maths. Chemistry and Biology are preferred. Subject to successful interview	B with no component below B	AAB
Management BSc (Hons)	FHSS	Maths and any two from Politics, Economics and Business and Management	A with A in Speaking and Listening and no component below B	AAB
Management (Accounting and Finance) BSc (Hons)	FHSS	Maths and any two from Politics, Economics and Business and Management	A with A in Speaking and Listening and no component below B	AAB
Management (Human Resources) BSc (Hons)	FHSS	Maths and any two from Politics, Economics and Business and Management	A with A in Speaking and Listening and no component below B	AAB
Management (Marketing) BSc (Hons)	FHSS	Maths and any two from Politics, Economics and Business and Management	A with A in Speaking and Listening and no component below B	AAB
Materials Science and Engineering BSc (Hons)*	FES	Two from Maths, Physics and Chemistry	C	AAA
Mathematics BSc (Hons)*	FES or FHSS	A* Maths, if taking Further Maths grade A must be achieved	C with no component below C	A*AB
Mathematics and Physics BSc (Hons)*	FES	Maths and Physics	B	A*A*A - A*AA
Mathematics and Statistics BSc (Hons)*	FES or FHSS	A* Maths, if taking Further Maths grade A must be achieved	C with no component below C (FES) (FHSS)	A*AB
Mathematics with Finance BSc (Hons)	FES or FHSS	A* Maths, if taking Further Maths grade A must be achieved	B with B in Writing and no component below C	A*AB
Mechanical Engineering BEng (Hons)*	FES	Maths and Physics	C	AAB
Mechatronic Engineering BEng (Hons)*	FES	Maths and either Physics, Further Maths or Chemistry	B	AAB
Medical Biochemistry BSc (Hons)*	FB	A in two sciences: Chemistry, Biology, Physics, Maths. Chemistry is compulsory, Biology is preferred. Subject to successful interview	B with no component below B	AAB
Molecular Biology BSc (Hons)	FB	A in two sciences: Chemistry, Biology, Physics, Maths. Chemistry is compulsory, Biology is preferred. Subject to successful interview	B with no component below B	AAB
Neuroscience BSc (Hons)*	FB	A in any two from Chemistry, Biology, Physics, Maths. Chemistry and Biology are preferred. Subject to successful interview	B with no component below B	AAB
Pharmacology BSc (Hons)*	FB	A in any two from Chemistry, Biology, Physics, Maths. Chemistry and Biology are preferred. Subject to successful interview	B with no component below B	AAB
Pharmacology and Physiology BSc (Hons)	FB	A in any two from Chemistry, Biology, Physics, Maths. Chemistry and Biology are preferred. Subject to successful interview	B with no component below B	AAB
Pharmacy MPharm (Hons)	FPH	Chemistry, Maths or Biology and one other rigorous academic subject. Subject to successful interview	A	ABB
Physics BSc (Hons)*	FES	Maths and Physics	B	A*A*A - A*AA
Physics with Astrophysics BSc (Hons)*	FES	Maths and Physics	B	A*A*A - A*AA
Politics and International Relations BSocSci (Hons)	FHSS	Politics	B with B in Writing and Speaking and no component below C	AAB
Politics, Philosophy and Economics BA (Hons)	FHSS	Maths and Economics	B	AAA
Psychology BSc (Hons)	FPS	At least one science subject	A with no component below B	AAB
Sociology BSocSci (Hons)	FHSS	Politics	B	ABB
Software Engineering BSc (Hons)*	FES	Maths and Further Maths or Maths and Physics	B	A*A*A*

Degree option with a year in industry also available.

Degree option with a year abroad or with overseas experience also available.

Please note: English level and academic progression requirements are correct to the best of our knowledge at the time of going to print. In some circumstances these may change throughout the year - please visit www.intostudy.com/manchester/courses for the most up to date information. Progression requirements, including English level and final grade, may be higher for degrees with a year in industry, year abroad/overseas placement, and with an integrated Master's.

* Also available as an integrated Master's

Find comprehensive information on all academic pathway programmes, degree options and progression requirements at: www.intostudy.com/manchester/courses

English courses

Improve your English language skills to prepare for further academic study

Start date

16 weeks: Aug
1-4 terms: Sep, Jan, Apr, Jun

English language entry requirements

From IELTS 3.0 or equivalent

Age requirement

16 years and above

Class size and hours

Maximum of 16 students
30 learning hours per week, with 25 hours of face-to-face contact

Note: 1 term = 11 weeks (10 of which are teaching weeks)

Improve your English language skills for work, socialising and travel

Start date

Jun, July, Aug, Sep, Oct, Nov and Dec

English language entry requirements

All English levels, from elementary to upper intermediate

Age requirement

16 years and above

Class size and hours

Maximum of 16 students
20 hours per week on average

EN Academic English



- For students who need to increase their IELTS level in order to progress to university. This intensive course offers rapid progress of up to one IELTS band per term.

Course features

- You will learn through face-to-face teaching and online learning to communicate effectively in English and improve your reading, writing, speaking and listening skills.
- A diverse social programme and effective academic content will help you to develop the fluency and confidence you need to progress to further study.
- Access INTO's interactive online learning platform, MyINTO, outside of class to practise your English language skills, complete tasks and engage with classmates.
- Developed in partnership with Cambridge English, the world leader in language assessment, INTO English Language Assessment (IELA) provides a standardised online assessment of all four core language skills throughout your studies. The IELA test is available to you as an additional form of assessment and allows you to choose from a wide range of Higher Education institutions

EN General English

- For students who want to increase their confidence in using everyday English for general life, work, socialising and travel in the UK.

Course features

- Build your confidence in core English language skills in everyday situations, from speaking, reading, listening and writing to vocabulary and grammar.
- Year-round courses have flexible start dates and course lengths, from 2-48 weeks. Take part in a range of activities and socialise with students from all over the world to build on your language ability.
- Take part in a range of activities and socialise with students from all over the world to build on your English language ability and make new friends.

"You can not find a better place to study English than in the UK. I learned about different cultures, behaviours and religions. I think it has been the biggest experience of my entire life!"

Nixander, Colombia
Studied General English at INTO Manchester



All our English language courses at INTO Manchester have received accreditation from the British Council.

Successful INTO alumni

We have an excellent success rate, giving you a great chance to progress to the next stage of your journey. Below, our students talk about what they have achieved on and after their INTO programme.

"I'm so grateful I studied at INTO Manchester because it prepared me so much for university. When applying for my graduate position, I think my international experience gave me an edge over other candidates."

Anoud, Jordan
Graduated with MPlan (Hons) Town and Country Planning with First Class Honours from The University of Manchester and now working as Town Planner at TEP (The Environmental Partnership)



"Without the Foundation I wouldn't have ended up studying at The University of Manchester, so I probably wouldn't be working in a job I love. The transition between INTO and university was so smooth it felt like it was the same course."

Ildar, Kazakhstan
Graduated with BEng (Hons) Civil Engineering from The University of Manchester



"Studying at INTO gave me a very special experience. I met a lot of friends there and they were all from different countries. I studied economics and politics which gave me a solid foundation and helped me to further my studies at the University."

Yanyu, China
Graduated with BSc (Hons) Management (Accounting and Finance) from The University of Manchester



"I developed skills I wouldn't have had the chance to if I'd stayed in Ecuador. The University also offered support for CV reviews and training for interviews, which definitely helped prepare me."

Daniel, Ecuador
Graduated with BA (Hons) International Business, Finance and Economics from The University of Manchester and now studying MA Development Studies in The Netherlands



"INTO Manchester was my first step into discovering my strengths and weaknesses, conquering new challenges and solving problems. It provided me with the understanding of different scientific subjects that will help me in the very near future."

Reem, Saudi Arabia
Currently studying BSc (Hons) Software Engineering at The University of Manchester



"The Foundation is crucial for your university success. It helps you to start speaking advanced English, get your head around the rules of academic writing, and be part of a multicultural society, making lots of friends from all over the world."

Iaroslav, Russia
Graduated with MChem (Hons) Chemistry with Industrial Experience from The University of Manchester

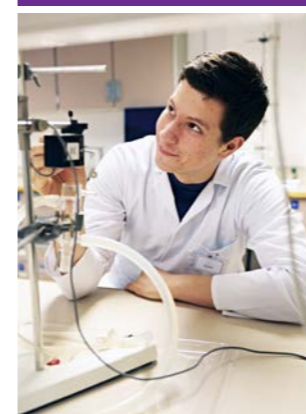

Dates and prices



The cost of your programme may vary depending on factors including the pathway chosen and programme length. The following guide to costs is based on pricing for the current academic year and provides an indication of the cost of attendance for some of our pathways. For specific cost information, please refer online: www.intostudy.com/manchester/courses

Estimated cost of attendance based on prices for current academic year 2019-2020						
Study length	Tuition	Accommodation	Books and fees	Airport pick up	Insurance	Total
Academic programmes						
International Foundation (3 term)	£17,795	£5,780-£9,600	£420-£820	£45	£357	£24,352-£28,572
International Foundation (4 term)	£22,225	£8,330-£12,185	£510	£45	£466	£31,531-£35,386
English language courses						
1 term*	£4,430	£1,870-£2,640	£90	£45	£122	£6,512-£7,282
16 weeks	£7,090	£3,035-£4,360	£130	£45	£145	£10,445-£11,770

Start months and term dates			
Academic programmes		Academic English	
June (4 term)	Mon 22 Jun 2020-Fri 18 Jun 2021	August (16 weeks)	Mon 10 Aug 2020-Fri 11 Dec 2020
September (3 term)	Mon 14 Sep 2020-Fri 18 Jun 2021	September (1 term)	Mon 28 Sep 2020-Fri 11 Dec 2020
September (4 term)	Mon 28 Sep 2020-Fri 27 Aug 2021	January (1 term)	Mon 11 Jan 2021-Fri 26 Mar 2021
January (3 term)	Mon 11 Jan 2021-Fri 27 Aug 2021	April (1 term)	Tue 06 Apr 2021-Fri 18 Jun 2021
		June (1 term)	Mon 28 Jun 2021-Fri 10 Sep 2021

Prices shown are for the current academic year of 01 September 2019 – 31 August 2020 and for indicative purposes only. We will confirm all tuition dates and prices for the academic year 2020/2021 on or before 20 January 2020, with the tuition prices being subject to a maximum increase of up to 5% on the prices for the current academic year. For full details of term dates, please visit the relevant course page at www.intostudy.com/manchester/courses

* The price will depend on your start date and length of study. Prices shown are only for one term. Vacation weeks in between terms are extra and will be charged at the weekly accommodation price.

 <p>Apply via your local INTO educational counsellor</p> <p>If you would like us to put you in contact with one of our counsellors, please contact us.</p>	 <p>Apply online</p> <p>Complete our online application form: apply.intostudy.com</p>	 <p>Need some help with your tuition fees?</p> <p>Check to see if you're eligible for a scholarship: www.intostudy.com/manchester/scholarships</p>
--	--	---

Discover more online

For students:
www.intostudy.com/manchester
For education counsellors:
partnerportal.intoglobal.com/manchester

Connect with us



Contact us

Enquiries and applications:
ukes@intoglobal.com
or +44 1273 876040
Visit the Centre:
marketing.manchester@intoglobal.com
or +44 161 631 1200

Centre address details:
INTO Manchester
Bridgewater House
58/60 Whitworth Street
Manchester
M1 6LT
United Kingdom



Through innovative partnerships with leading universities, we expand opportunities for higher education, ensuring success and transforming the lives of our students and staff.

INTO GIVING

Working across the globe, INTO Giving supports projects that increase access to education and improve the quality of teaching and learning. For more information visit www.into-giving.com

© INTO Manchester Limited, September 2019. Every effort is made to ensure that content published in this document is correct at the time of publication. However, from time to time there may be occasions where some of the information has changed since the date of publication. The most up to date information can be found on our website at www.intostudy.com/manchester – please refer to this before submitting your application. If, in our opinion, we consider that any change has been made which has a material impact on any offer that has been made to you to study with us, we will inform you of these changes in writing. The information provided in this document is subject to INTO Manchester in partnership with The University of Manchester's terms and conditions which can be accessed at www.intostudy.com/manchester/terms.

INTO Manchester Limited, 6438137, One Gloucester Place, Brighton, East Sussex, BN1 4AA, UK.

Education provider sponsor number 6FY6FQBVI

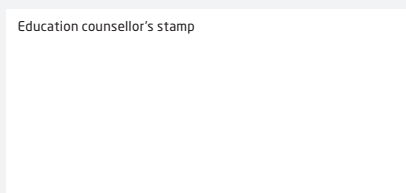

The University of Manchester