

INTO 

 UNIVERSITY OF
GLOUCESTERSHIRE

University
pathways

for international students

2019-2020



Contents

- 5 About the University
- 6 Life on campus
- 8 Discover Gloucestershire
- 9 Home from home
- 10 Choosing your course
- 11 Integrated Programme
- 11 Top-up Degree
- 12 International Foundation
- 13 International Year One
- 15 Pre-Master's
- 16 English courses
- 17 Successful INTO alumni
- 18 Progression degree overview table
- 20 Dates and prices

Join a supportive, vibrant community

Welcome to INTO University of Gloucestershire, your stepping stone to an internationally-recognised degree from the University of Gloucestershire. We give international students like you the opportunity to study at the university ranked in the UK top 5 for international student support.

Top 5

in the UK for international student support

(International Student Barometer 2017)

170⁺

year history of education dating back to 1847



for teaching quality

(Teaching Excellence Framework 2017)

At INTO University of Gloucestershire, you'll study a specialist programme that is specifically tailored to the requirements of the University. We'll help you to improve your English language skills, adjust to life as a student at the University of Gloucestershire, and achieve academic success at an outstanding institution.

You'll study and socialise on the beautiful Park campus before progressing to your degree at the University of Gloucestershire – many of which include professional accreditation, so you can be sure that throughout your studies you'll develop the skills that matter in the workplace.

Choosing to study abroad is a big decision, but with INTO University of Gloucestershire you can relax knowing that you'll have a fantastic experience and graduate with a qualification that transforms your future.

Choose #INTOUOG and open up a lifetime of opportunities.



University of Gloucestershire's UK top-ranked subject areas

 6th Criminology*	 9th Film Production and Photography*	 Top 20 Sports Science*	 Top 30 Geography and Environmental Studies*
 Top 30 Biosciences*	 Top 40 Fashion and Textiles*	 Top 50 Business, Management and Marketing*	 Top 50 Journalism, Publishing and PR*

* Guardian University Guide 2019



About the University

Study here and you'll join a close-knit, supportive community of staff and students who share your passions, academic interests and goals. With career-focussed degrees, you'll develop the confidence, skills and experience you need to achieve your ambitions.

170+ year history

The University of Gloucestershire has a strong history of providing education dating back to 1847, growing into a university with more than 10,000 students across three campuses over its 170-year history. It's a popular choice for students from the UK, so at the University of Gloucestershire you'll enjoy a typical British university experience.

Close-knit community

As soon as you set foot on any one of the University's three campuses, you'll feel the welcoming environment of a university with a vibrant and inclusive community. The warm and friendly network of support staff is one of the reasons why the University has been voted one of the top 5 in the UK for international support (International Student Barometer 2017).

Inspiring academics

The University is committed to academic excellence and ensuring the quality of the degree you study, the teaching you receive, and its research. Whichever degree you choose, you'll learn from passionate lecturers with industry experience, and have the opportunity to explore your subject in depth. The University is among the top universities in the UK for National Teaching Fellowships, having been awarded 16 since the scheme began.

Your Future Plan

Whether you know what to do after graduation or would like to explore your options, at Gloucestershire you'll develop the skills and experience you need to have a successful career. You'll benefit from your lecturers' industry connections, with workshops and guest speakers allowing you to build your network of contacts. Through 'Your Future Plan', you'll be able to access a range of exciting opportunities, from field trips to work placements, enabling you to become the best graduate you can be.



"Students choose the University of Gloucestershire for our wide variety of industry-relevant degrees. Our international students tell us how much they enjoy our safe, vibrant, central location and the excellent learning environment."

Stephen Marston, Vice Chancellor



Life on campus

You'll begin your studies on Park campus, where the welcoming and supportive environment will encourage you to get fully involved in university life. Surrounded by nature and only a 20-minute walk from Cheltenham town centre, it's a beautiful and inspiring place to live and study.

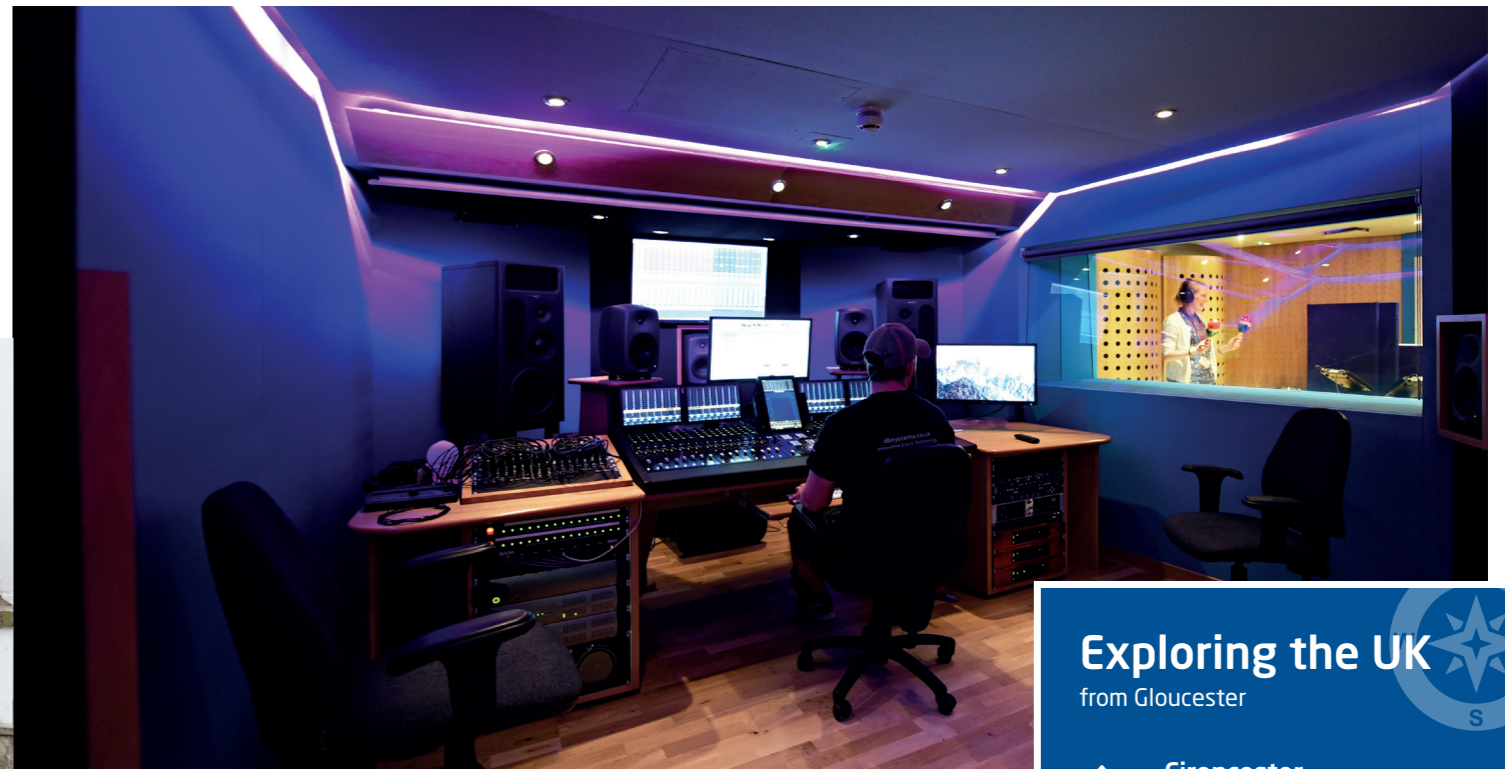

Top 10
in the UK for
Student Support
(Whatuni Student Choice Awards 2017)



94%
overall student satisfaction
(INTO Annual Experience Survey 2018)



Exploring the UK

from Gloucester

- Cirencester**
A traditional English town known as the capital of the Cotswolds
30 minutes by coach
- Bristol**
A vibrant harbourside city full of energy, culture and history
40 minutes by train
- Cardiff**
Full of character and heritage, Cardiff is the capital of Wales
1 hour 20 minutes by train
- London**
One of the world's best cities, famous for its history and culture
2 hours 10 minutes by train

Your Study Centre

The Centre is located on Park campus in the newly-refurbished Pallas Villa and Cornerways buildings, which are close to everything you need - from the library to the Students' Union. From the moment you arrive, you'll become a real part of the University community, getting to know students from countries all over the world and exploring your new surroundings.

Supporting you

Our Student Services team will help you settle into life in Cheltenham. Whether you're opening a bank account, planning a trip or have a question about your studies, we are here for you. There's a 24-hour telephone helpline if you need to speak to someone during out-of-office

hours, and if you're under 18 we offer extra support including arranging your safe transfer from the airport. You'll also be given a dedicated named person to contact to ensure your wellbeing and you'll receive a copy of our code of conduct, which you must follow - especially outside of class when you will be unsupervised.

For more information on our policies, including a copy of our Under 18 Policy, visit www.intostudy.com/gloucestershire/terms

Progressing to Gloucestershire

You'll also get plenty of support from the University. The University's Progression Manager will provide you with one-to-one advice and support throughout your progression journey. This will include giving you the opportunity to attend progression events and open days, and meeting with your course leaders to ensure you are fully informed about the degree programme you will be studying.

Top specialist facilities

Once you progress to your degree you'll have access to some amazing subject-specific facilities.

- Brand new Media Centre with studios; galleries; recording studios and music production labs.
- Computing and Technology Suite with state-of-the-art technology.
- Two art studios, a dark room, processing room and Mac suites.
- Purpose-built Performing Arts and Events Centre,
- Brand new Business School with Thomson Reuters Trading Room featuring simulation terminals for access to live financial data.

Get involved

There's more to campus life than just studying. The orientation programme in your first week will give you the chance to meet other INTO students. Day trips, excursions and parties organised by the Student Services team at the Centre will keep you busy throughout the year too.

The Students' Union offers over 80 clubs and societies, so whether you already have a passion or want to pursue something new, there's loads of opportunities to learn new skills, make friends and have fun. From Anime and Athletics to Film and Football, you're sure to find something that's perfect for you.

Estimated monthly budget

Food	£120
Entertainment	£100
Travel (local)	£40
Clothes and toiletries	£60
Other expenses	£40

All costs are estimates and intended as an indicative guide only.

Discover Gloucestershire

Located on the edge of the Cotswolds, an area of outstanding natural beauty, Cheltenham is a typically English town full of history and culture. With the bustling city of Gloucester just six miles away, there's something for everyone in Gloucestershire.



Friendly

Gloucester is the 2nd friendliest city in the UK (Business Insider UK 2017)



Charming Cheltenham

Park campus is just a 20-minute walk from Cheltenham, a town steeped in history. The Brewery Quarter is a buzzing district where you'll find plenty to keep you entertained, from watching a film at Cineworld to ten-pin bowling at Hollywood Bowl.

The town is home to a variety of boutiques and international stores. Head to Montpellier or The Suffolks for a spot of independent shopping, or to the Promenade and Regent Arcade for all the top brands. For a taste of culture, visit the local theatre to enjoy a variety of live shows – from musicals to comedy.

Vibrant Gloucester

Gloucester has the lively atmosphere you'd expect from a thriving student city – and it's just 25 minutes from Park campus on the University's dedicated inter-campus bus.

King's Walk and Eastgate shopping centres have all the high street stores you need, while in the Cathedral Quarter you'll discover friendly and independent boutiques. Gloucester Quays Outlet offers the best in discounted shopping.

For something different, head to The Warehouse, an indoor climbing centre, or to JDR Karting for karting, lasertag or a Segway experience.

Festival scene

Gloucestershire is famous for its festival scene. With over 45 festivals a year, there really is something for everyone, including horse racing, jazz, science, food and drink, comedy and literature.

Your home from home

With a choice of accommodation options, including student residences within easy reach of the Centre and homestay accommodation with approved hosts, we make finding somewhere to live easy.

Park Villas

On Park campus just minutes away from the INTO Centre are the five buildings which make up Park Villas. You'll have a private single study bedroom, and share a kitchen and living space with 9-10 other students.

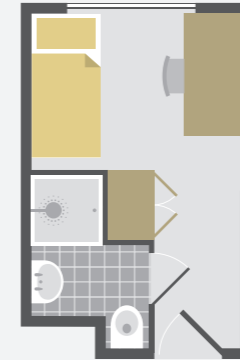

- On campus
- Walk to INTO Centre
- En suite bathroom
- Laundry facilities
- Wi-Fi
- 24/7 staff



Park Challinor

This residence, situated on Park campus, has been recently renovated to a high standard. There's a mixture of en suite rooms and rooms with shared bathroom facilities, and you'll share a kitchen and living space with between 7 and 10 other students.

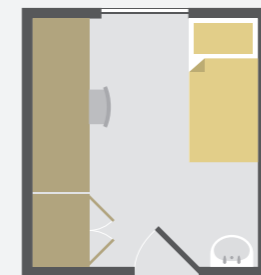

- On campus
- Walk to INTO Centre
- Shared bathroom
- Laundry facilities
- Wi-Fi
- 24/7 staff

Homestay

This is a unique opportunity to experience British life and culture first hand. You'll have a private room in a carefully selected host's home, sharing mealtimes and living spaces.

Supporting you

In our residences you'll find on-site staff available 24/7 to offer support, and we'll also provide you with a 24-hour helpline telephone number. If you're under 18 when you start your programme, you'll stay in homestay accommodation until you have turned 18 to ensure you have all the support you need.



Take a look around our accommodation:

www.myin.to/UGOAccommodation

Choosing your course

Prepare for your university degree with our tailored, academic pathway programmes designed in partnership with the University of Gloucestershire. You'll benefit from university-style teaching on subject-based modules and high academic standards. Then, when it comes to progressing to your chosen degree, we'll support you with your university application.

FIND YOUR ENTRY LEVEL

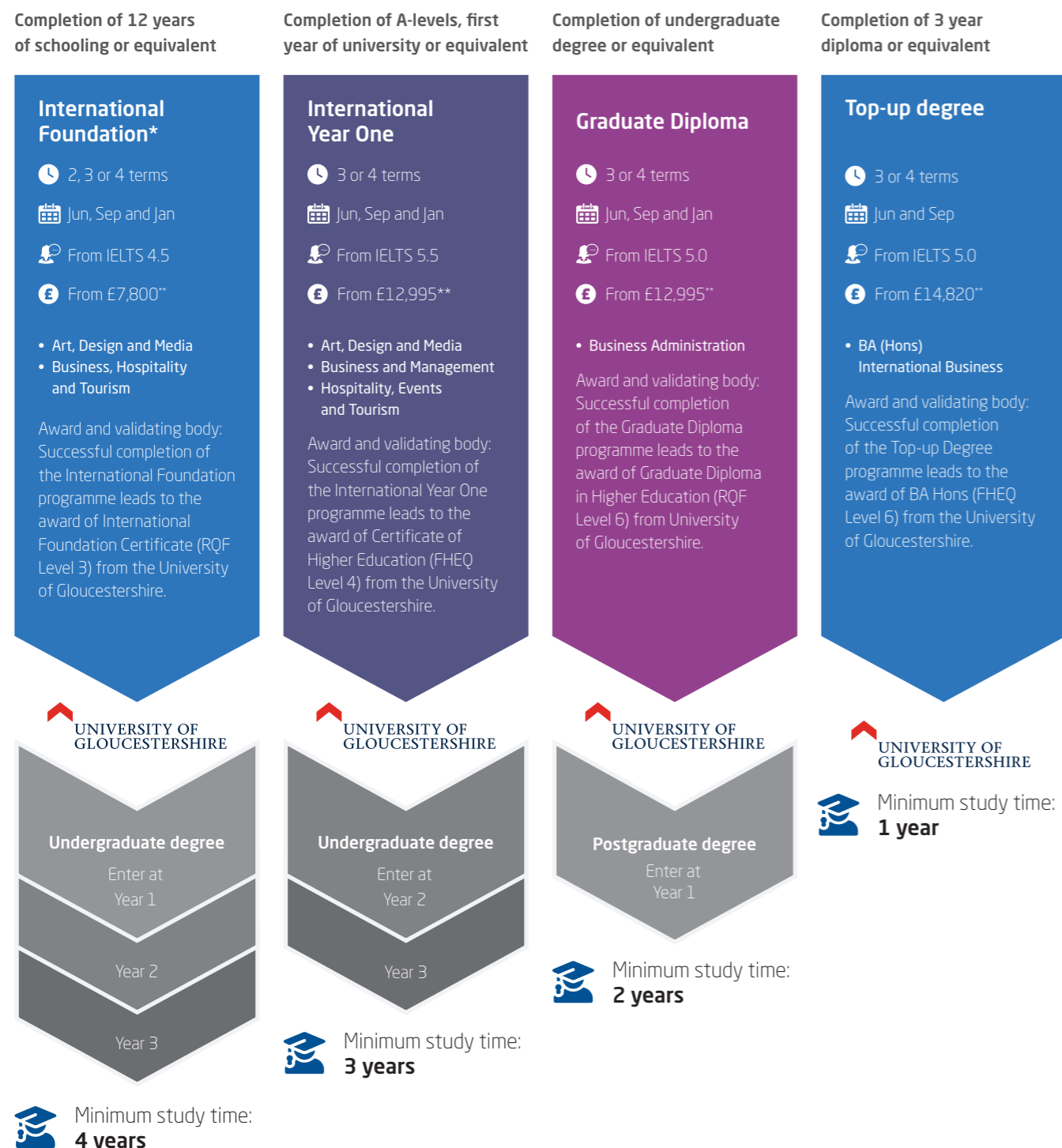

BEGIN YOUR CAREER

Please note that course length and start month options may vary depending on the pathway chosen. Please visit www.intostudy.com/gloUCEstershire/courses for full information.
* Also available as an Undergraduate Degree with International Foundation.

** Prices shown are for the current academic year 01 September 2018- 31 August 2019 and are for indicative purposes only. All prices are subject to an increase of up to 4%.

Undergraduate Degree with International Foundation - IIF

- Combine your Foundation year and undergraduate degree in one programme.
- As a single year of study, you can apply for one visa for the full duration of your programme.

Special features

Year 1 of study plan

- Improve your English language skills, increase your knowledge of academic theory and develop your understanding of key academic subjects related to your degree.
- Develop the study and research skills that will prepare you for undergraduate study when you move into Year 2 of your study plan.

- Benefit from regular one-to-one tutorial meetings with your Personal Tutor where you discuss your achievements, progress and plan for future study.
- Benefit from knowing that you will continue directly to the first year of your chosen undergraduate degree in Year 2 of your study plan, provided you meet the minimum English language and academic grade requirements.

What will I study?

Core modules

English Language for Foundation Study (15 credits)
Academic Skills for Foundation Study (15 credits)

Specialist modules

You will also study a number of specialist modules that will vary depending on your chosen degree. Find out more online.

Available for **18** degrees.

BA (Hons) International Business

- Build on existing study from your home country and gain a UK degree after nine months of study.
- Progress to a Master's degree at the University of Gloucestershire, and achieve two degrees in two years.

What will I study?

You will need to earn 120 credits from the following module options to successfully complete your pathway programme:

Context of International Business (15 credits)	Managing Operations Globally (15 credits)
Cultural Issues in Management (15 credits)	Managing Change (15 credits)
English Language and Study Skills (15 credits)	New Business Enterprise (15 credits)
Investigative Study (15 credits)	Strategies for Globally Responsive Leadership (15 credits)

Find out more online at www.intostudy.com/gloUCEstershire/TUD

Combine International Foundation study with a University of Gloucestershire degree

Class information

Class size

Year 1 of study plan: maximum of 16 students per class for English language teaching

Class hours

Year 1 of study plan: 18 hours per week minimum

Age requirement

16 years and above*

English language entry requirements

IELTS 5.5 (with a minimum of 5.5 in all subskills) or equivalent

Undergraduate Degree with International Foundation and Pre-Sessional English

10 week, 20 hour Pre-sessional: IELTS 5.0 (with a minimum of 5.0 writing and reading subskills) or equivalent

10 week, 25 hour Pre-sessional: IELTS 4.5 (with a minimum of 4.5 writing and reading subskills) or equivalent

If you do not meet the English language requirements you should apply for a pathway (see page 12) or Academic English course (see page 16).

*All students commencing courses on a published September start date must be 16 years old by 01 September that calendar year. All students commencing courses for the January start date must be 16 by 01 September 2019.

Top up your existing studies and gain a degree in 9 months

Class Information

Class size

Maximum of 16 students per class for English language teaching

Class hours

18 hours per week minimum

English language requirements

3 term: IELTS 6.0 (with a minimum of 5.5 in all subskills) or equivalent

Top-up Degree with Pre-Sessional English

4 term: including a 10 week, 25 hour Pre-sessional: IELTS 5.0 (with a minimum of 5.0 writing and reading subskills) or equivalent

If you do not meet the minimum English language requirements you should apply for our Academic English course. See page 16 for more information.

Progress to Year 1 of an undergraduate degree at the University of Gloucestershire

Class information

Class size
Maximum of 16 students per class for English language teaching

Class hours
18 hours on average per week

Age requirement
16 years and above*

English language entry requirements

2 term**: IELTS 4.5 (with a minimum of 4.5 in all subskills) or equivalent

3 term: IELTS 4.5 (with a minimum of 4.0 in all subskills) or equivalent

4 term: IELTS 4.0 (with a minimum of 4.0 in all subskills) or equivalent

If you do not meet the minimum English language requirements you should apply for our Academic English course. See page 16 for more information.

* All students commencing courses on a published September start date must be 16 years old by 01 September that calendar year. All students commencing courses for the January start date must be 16 by 01 September 2019.

**Business, Hospitality and Tourism pathway only.

Prepare to progress to a degree at the University of Gloucestershire:

Top 10

in the UK for Film Production and Photography

(Guardian University Guide 2019)

11th

in the UK for Hospitality, Leisure, Recreation and Tourism

(The Complete University Guide 2019)

Watch our video about International Foundation:
www.myin.to/InternationalFoundation

International Foundation

Art, Design and Media – FADM

- > Create a portfolio of projects to showcase skills, personality and creativity.
- > Experiment with different materials and learn using industry-standard tools such as Adobe Photoshop and InDesign.

What will I study?

You will need to earn 120 credits from the following module options to successfully complete your pathway programme:

Quantitative Methods (15 credits)	Concepts in Art, Design and Media (15 credits)
Art, Design and Media Practice (15 credits)	Creative Skills (15 credits)
Final Major Project in Art, Design and Media (15 credits)	English Language for Foundation Study (45 credits)

Progress to **27** degrees. Find out more online at www.intostudy.com/gloucestershire/FADM

Business, Hospitality and Tourism – FBHT

- > Visit local organisations and locations related to degree subjects.
- > Gain real-life experience by analysing the practices of global businesses such as Apple

What will I study?

You will need to earn 120 credits from the following module options to successfully complete your pathway programme:

Quantitative Methods (15 credits)	1 of 3:
Introduction to Accounting (15 credits)	Introduction to Law and Legal Systems (15 credits)
Investigating the Leisure Industries (15 credits)	Operational Skills for Hospitality, Events and Tourism (15 credits)
The World of Business (15 credits)	Business Decision Making (15 credits)
English Language for Foundation Study (45 credits)	

Progress to **32** degrees. Find out more online at www.intostudy.com/gloucestershire/FBHT

International Year One

Art, Design and Media – YOADM

- > Take part in interactive and practical classes and learn alongside current students at the University.
- > Participate in the University's annual Art and Design show.

What will I study?

You will need to earn 120 credits from the following module options to successfully complete your pathway programme:

Academic Skills for Undergraduate Study (15 credits)	Examples of specialist modules include: Advertising, Design and Art Direction (15 credits), Developing Creative Practice (15 credits), Games Production (15 credits) and Introduction to Studio and Constructed Photography (15 credits)
English Language for Undergraduate Study (30 credits)	

Progress to **10** degrees. Find out more online at www.intostudy.com/gloucestershire/YOADM



"One of my favourite modules is Learning Creative Thinking because they teach us to think in a different way. I really like it here because they want us to be creative. I want to take some of this creativity back to Hong Kong – this is my dream."

Tiffany, Hong Kong
Completed International Year One and progressed to Graphic Design at the University of Gloucestershire

Penguin Random House Student Design Award 2017

"I am extremely honoured to receive such an important award from Penguin Random House Student Design Award, Children's category. I never thought I would be standing there and receiving the 2nd prize out of more than 2,000 entries. Take a look at my book cover design for The Secret Diary of Adrian Mole."



Progress to Year 2 of an undergraduate degree at the University of Gloucestershire

Class information

Class size
Maximum of 16 students per class for English language teaching

Class hours
18 hours on average per week

Age requirement
17 years and above

English language entry requirements

3 term: IELTS 5.5 or equivalent

4 term: IELTS 5.0 or equivalent

If you do not meet the minimum English language requirements you should apply for our Academic English course. See page 16 for more information.

Prepare to progress to a degree at the University of Gloucestershire:

Top 40

in the UK for Fashion and Textiles

(Guardian University Guide 2019)

Watch our video about International Year One:
www.myin.to/InternationalYearOne

Progress to Year 2 of an undergraduate degree at the University of Gloucestershire

Class information

Class size
Maximum of 16 students per class for English language teaching

Class hours
18 hours on average per week

Age requirement
17 years and above

English language entry requirements

3 term: IELTS 5.5 or equivalent

4 term: IELTS 5.0 or equivalent

If you do not meet the minimum English language requirements you should apply for our Academic English course. See page 16 for more information.

Prepare to progress to a degree at the University of Gloucestershire:

Top 50

in the UK for Business, Management and Marketing

(Guardian University Guide 2019)

11th

in the UK for Hospitality, Leisure, Recreation and Tourism

(The Complete University Guide 2019)

Business and Management – YOBM

- › Enjoy practical learning and attend events within the University's Business School.
- › Apply knowledge in practice by developing a marketing plan.

What will I study?

You will need to earn 150 credits from the following module options to successfully complete your pathway programme:

Academic Skills for Undergraduate Study (15 credits)	Business Information (15 credits)
English Language for Graduate Study (30 credits)	Consumer Behaviour (15 credits)
Business Environment (15 credits)	Introduction to Management (15 credits)
Business Finance (15 credits)	Business Cases (15 credits)
	Introduction to Marketing (15 credits)

Progress to **6** degrees. Find out more online at www.intostudy.com/gloucestershire/YOBM

Hospitality, Events and Tourism – YOHE

- › Learn through university-style teaching and apply your knowledge in a real work environment
- › Improve skills by reviewing group presentations.

What will I study?

You will need to earn 150 credits from the following module options to successfully complete your pathway programme:

Academic Skills for Undergraduate Study (15 credits)	Examples of specialist modules include:
English Language for Undergraduate Study (30 credits)	Introduction to Sports and Music Events (15 credits), Hotel Operations Management (15 credits) and Tourism in the World (15 credits)

Progress to **3** degrees. Find out more online at www.intostudy.com/gloucestershire/YOHE



"I didn't just win the Gloucestershire Employability Gold Award, I also "won" a lot of new experiences and met a lot of awesome people within the hospitality industry. I completed the whole Gloucestershire Employability Award Scheme in one academic year – I am so proud of myself! I feel like there are more things I can do, I won't know it until I push myself to the limit!"

Yin Nam, Hong Kong
Completed International Year One and progressed to Hotel Resort and Tourism Management (with a placement year)

Graduate Diploma

Business Administration – GDBA

- › Benefit from the University's close links with business including the BBC and Superdry.
- › Gain insight into applying theory from local professionals.

What will I study?

You will need to earn 120 credits from the following module options to successfully complete your pathway programme:

Academic Skills for Graduate Study (15 credits)	International Marketing (15 credits)
English Language for Graduate Study (45 credits)	Management Accounting (15 credits)
Human Resource Management (15 credits)	Study Skills for Graduate Study (15 credits)

Progress to **5** degrees. Find out more online at www.intostudy.com/gloucestershire/GDBA

Pre-Master's English and Academic Study Skills

- › Improve and develop the language, study and research skills necessary to study a postgraduate degree.
- › Learn how to give presentations, acclimatise to the culture of a UK university and adjust to the demands and challenges of higher education.

Special features

- Improve your academic English, research and study skills before postgraduate study.
- Develop your subject vocabulary in business topics including Human Resource Management, Finance and Planning and Marketing.
- Benefit from regular one-to-one meetings with your personal tutor where you will discuss your progress and plan for effective future study.
- Become accustomed to living and studying in the UK in advance of your postgraduate degree.

Progress to **4** degrees. Find out more online at www.intostudy.com/gloucestershire/PME

Progress to a postgraduate degree at the University of Gloucestershire

Class information

Class size
Maximum of 16 students per class for English language teaching

Class hours
18 hours on average per week

Age requirement
21 years and above

English language entry requirements

3 term: IELTS 5.5 or equivalent

4 term: IELTS 5.0 or equivalent

If you do not meet the minimum English language requirements you should apply for our Academic English course. See page 16 for more information.

Progress to a postgraduate degree at the University of Gloucestershire

Class information

Class size
Maximum of 16 students per class

Class hours
20 hours per week on average

Age requirement
21 years and above

English language entry requirements

IELTS 5.5 (with a minimum of 5.5 in all subskills) or equivalent

If you do not meet the minimum English language requirements you should apply for our Academic English course. See page 16 for more information.

English courses

Improve your English language skills to prepare for further academic study

Class information

Class size
Maximum of 16 students

Class hours
30 learning hours per week, with 25 hours of face-to-face contact

Age requirement
16 years and above

English language entry requirements
From IELTS 3.0

Improve your English language skills to the level required by your chosen degree

Class Information

Class size
Maximum of 16 students for English language teaching

Class hours
20-21 hours per week on average

Age requirement
17 years and above

English language entry requirements
10 weeks: IELTS 5.0 (with nothing less than 5.0 in subskills and at least one subskill at 5.5) or equivalent

Improve your English language skills for work, socialising and travel

Class Information

Class size
Maximum of 16 students for English language teaching

Class hours
20 hours per week on average

Age requirement
16 years and above

English language entry requirements
All English levels, from beginner to advanced

EN Academic English



Accredited by the
BRITISH COUNCIL
for the teaching of English in the UK

- > Intensive course offering rapid progress of up to the equivalent of one IELTS band per term.
- > Blend of traditional face-to-face contact and online learning.

Course features

- Improve your reading, writing, speaking and listening skills, and learn to communicate effectively in English.
- Develop the fluency and confidence you need to progress to further study.
- A blended learning approach offers you the best of traditional classroom teaching, which is combined with online content. You'll access both in and outside of class.
- 24/7 access to 'MyINTO', our interactive online learning platform. It gives you the flexibility to study at times that suit you and engage with other students outside of class.
- A standardised online assessment developed in partnership with Cambridge English used to monitor progress through your course.
- Develop your confidence and fluency outside of the classroom through a diverse social programme.

EN Pre-session English

- > Designed to improve your English language skills to the level required by your chosen degree.
- > Intensive language and study skills taught by experienced teachers will prepare you for living and studying at the University of Gloucestershire..
- > Learn how to give presentations on different areas of academic interest and enhance your vocabulary related to your degree.

Course features

- If you're academically qualified, hold an offer from the University of Gloucestershire and need to improve your English language level, this short 10 week course is ideal for you.
- Learn alongside students who will be studying the same – or similar – subjects at the University, with teaching and assessments that are tailored to the requirements of university study.
- Understand contextual study skills, acclimatise to British culture and adjust to the demands, challenges and expectations of UK higher education.

EN General English

- > Improve your English language skills with an INTO General English course.
- > Designed to increase your confidence in using everyday English, from speaking and writing to vocabulary and grammar.
- > Year-round courses with flexible start dates and course lengths, from 2 to 42 weeks.

Course features

- Specifically tailored to provide you with the language skills you need for life, work, socialising and travel.
- Learn in a relaxed and inspiring environment with knowledgeable and supportive teachers.
- Take part in a range of activities and socialise with students from all over the world to build on your language ability.

Successful INTO alumni

We have an excellent success rate, giving you a great chance to progress to the next stage of your journey. Our latest progression results demonstrate just how well our students achieve on their INTO programme...

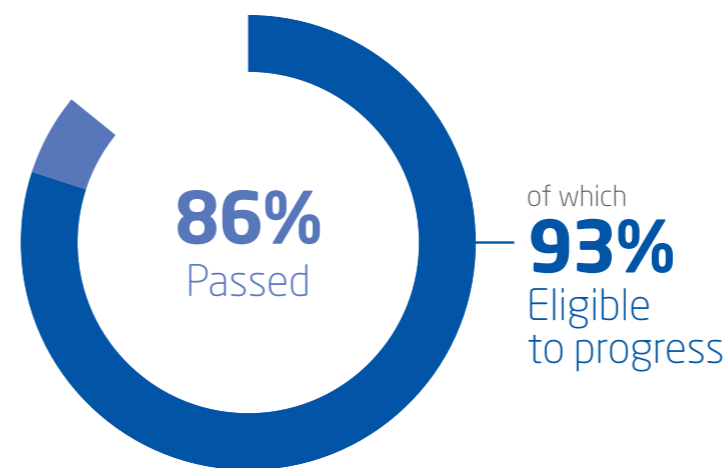

Student progression results 2016-17

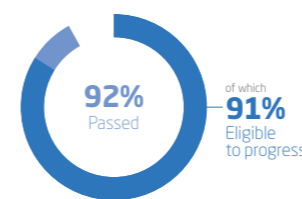

International Foundation

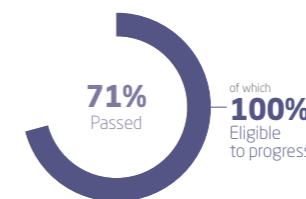

International Year One



Graduate Diploma

"The Progression Manager at INTO University of Gloucestershire really helped me to look at my options for progression so that I could find the best course for me. This was the bridge between my INTO Foundation course and my University degree. I am now studying a fun and interactive degree which I really enjoy!"

Iky, Singapore
Completed International Foundation and is now studying BA (Hons) Television Production at the University of Gloucestershire

"I chose INTO University of Gloucestershire because of the University's excellent business school and facilities. The teachers are really helpful and encouraging, and they're supporting me in my plans to progress further in the University."

Emmanuel, Zimbabwe
Completed International Foundation and progressed to Business Management at the University of Gloucestershire



"The tutors here are friendly and I feel confident to talk with them. The course has improved my language ability and basic business knowledge, like in the Introduction to Marketing and the Business Environment modules."

Hong, Malaysia
Completed International Year One and progressed to Business Management at the University of Gloucestershire

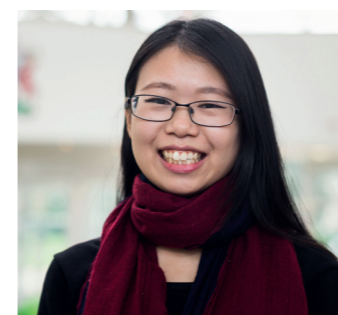

"The foundation year of the course has prepared me for university because we learn how to use related equipment and software and we have creative thinking modules. The atmosphere in the class is really nice."

Shudan, China
Currently studying Integrated Programme in Landscape Architecture



Passed: % passers of those who completed | Eligible: % eligible to progress of those who passed

Progression degree overview table

There are more than 70 progression degree options at the University of Gloucestershire. You can progress to any of these from one of our INTO University of Gloucestershire pathway programmes. Below is a selection of some of the most popular. See pages 10-14 for more details on the pathways.

Find comprehensive information on all academic pathway programmes, degree options and progression requirements at: www.intostudy.com/gloucestershire/courses

70+ progression degree options

Undergraduate

Degree	Pathway(s)	Specific requirements	English level %	Final grade %
International Foundation				
Accounting and Business Management BA (Hons)	FBHT	Interview required	40	50
Accounting and Finance BA (Hons)*	FBHT or IIF	None	40	50
Accounting and Financial Management Studies BA (Hons)	FBHT	None	40	50
Advertising BA (Hons)*	FADM or IIF	Portfolio and interview required	40	50
Animal Biology BSc (Hons)	FBHT	None	40	50
Animation BA (Hons)*	FADM or IIF	Portfolio and interview required	40	50
Biology BSc (Hons)	FBHT	None	40	50
Business and Marketing Management BA (Hons)*	FBHT or IIF	None	40	50
Business Computing BSc (Hons)	FBHT	None	40	50
Business Management BA (Hons)*	FBHT	None	40	50
Computer and Cyber Forensics BSc (Hons)	FBHT	None	40	50
Computer Games Design BSc (Hons)*	FADM or IIF	Interview required	40	50
Computer Games Programming	FADM	Interview required	40	50
Computing BSc (Hons)	FBHT	None	40	50
Creative Music Technology BA (Hons)	FADM	Portfolio and interview required	40	50
Creative Writing BA (Hons)	FADM	None	40	50
Criminology BSc (Hons)	FBHT	None	40	50
Criminology and Psychology BSc (Hons)	FBHT	None	40	50
Criminology and Sociology BSc (Hons)	FBHT	None	40	50
Cyber and Computer Security BSc (Hons)	FBHT	None	40	50
Dance BA (Hons)	FADM	Audition required	40	50
Dance and Performance Practice BA (Hons)	FADM	Audition required	40	50
Digital Marketing BA (Hons)	FBHT	None	40	50
Digital Media and Web Technologies BSc (Hons)	FADM	Portfolio and interview required	40	50
Ecology and Environmental Science BSc (Hons)	FBHT	None	40	50
Education BA (Hons)	FBHT	None	40	50
Events Management BA (Hons)	FBHT	None	40	50
Fashion Design BA (Hons)	FADM	Portfolio and interview required	40	50
Film Production BA (Hons)*†	FADM	Portfolio and interview required	40	50
Fine Art BA (Hons)	FADM	Portfolio and interview required	40	50
Geography BA/BSc (Hons)	FBHT	None	40	50
Graphic Design BA (Hons)*	FADM or IIF	Portfolio and interview required	40	50
Hotel, Resort and Events Management BA (Hons)*	FBHT	None	40	50
History BA (Hons)	FBHT	None	40	50
Hotel, Resort and Tourism Management BA (Hons)	FBHT	None	40	50
Illustration BA (Hons)*	FADM or IIF	Portfolio and interview required	40	50
Interior Design BA (Hons)*	FADM or IIF	Portfolio and interview required	40	50
International Business Management BA (Hons)*	FBHT or IIF	None	40	50
International Business Studies BA (Hons)	FBHT	None	40	50
Journalism BA (Hons)	FADM	IELTS level 7 and interview required	40	50
Landscape Architecture BA (Hons)*	FADM or IIF	Portfolio and interview required	40	50
Law LLB (Hons)*	FBHT or IIF	None	40	50
Magazine Journalism and Production BA (Hons)	FADM	Portfolio and interview required	40	50
Marketing, Advertising and Branding BA (Hons)*	FBHT or IIF	None	40	50

Degree	Pathway(s)	Specific requirements	English level %	Final grade %
Media Production BA (Hons)*	FADM or IIF	Portfolio and interview required	40	50
Music Business BA (Hons)	FADM	Portfolio and interview required	40	50
Performing Arts BA (Hons)	FADM	Audition required	40	50
Photography BA (Hons)*	FADM or IIF	Portfolio and interview required	40	50
Photojournalism and Documentary Photography BA (Hons)	FADM	Portfolio and interview required	40	50
Physical Education BSc (Hons)	FBHT	None	40	50
Physical Education and Teaching BSc (Hons)	FBHT	None	40	50
Popular Music Ba (Hons)	FADM	Portfolio and interview required	40	50
Product Design BA (Hons)	FADM or IIF	Portfolio and interview required	40	50
Psychology BSc (Hons)	FBHT	None	40	50
Sociology BSc (Hons)	FBHT	None	40	50
Sport and Exercise Sciences BSc (Hons)	FBHT	None	40	50
Professional Photography for the Creative Industries BA (Hons)	FADM	Portfolio and interview required	40	50
Sport Business Management BA (Hons)*	FBHT or IIF	None	40	50
Sports Coaching BSc (Hons)	FBHT	None	40	50
Sports Coaching and Development BSc (Hons)	FBHT	None	40	50
Sports Journalism BA (Hons)	FADM	Interview required	40	50
Sports Strength and Conditioning BSc (Hons)	FBHT	None	40	50
Sports Therapy BSc (Hons)	FBHT	None	40	50
Television Production BA (Hons)	FADM	Portfolio and interview required	40	50

International Year One

Accounting and Business Management BA (Hons)	YOBM	None	40	40
Advertising BA (Hons)*	YOADM	Portfolio and interview required	40	40
Business Management BA (Hons)*	YOBM	None	40	40
Computer Games Design Bsc (Hons)*	YOADM	Interview	40	40
Digital Marketing BA (Hons)	YOBM	None	40	40
Digital Media and Web Technologies BSc (Hons)	YOADM	Portfolio and interview required	40	40
Events Management BA (Hons)	YOHET	None	40	40
Fashion Design BA (Hons)	YOADM	Portfolio and interview required	40	40
Graphic Design BA (Hons)*	YOADM	Portfolio and interview required	40	40
Hotel, Resort and Events Management BA (Hons)*	YOHET	None	40	40
Hotel, Resort and Tourism Management BA (Hons)	YOHET	None	40	40
Illustration BA (Hons)*	YOADM	Portfolio and interview required	40	40
Interior Design BA (Hons)*	YOADM	Portfolio and interview required	40	40
International Business Management BA (Hons)*	YOBM	None	40	40
International Business Studies BA (Hons)	YOBM	None	40	40
Marketing, Advertising and Branding BA (Hons)*	YOBM	None	40	40
Photography BA (Hons)*	YOADM	Portfolio and interview required	40	40
Product Design BA (Hons)*	YOADM	Portfolio and interview required	40	40
Professional Photography for the Creative Industries BA (Hons)	YOADM	Portfolio and interview required	40	40

Postgraduate

Degree	Pathway(s)	Specific requirements	English level %	Final grade %
Graduate Diploma				
Business Administration MBA	GDBA	None	50	50
Finance MSc	GDBA	Undergraduate degree in Accounting, Finance, Economics or similar	50	50
Human Resources Management MSc	GDBA	None	50	50
International Business MSc	GDBA	Undergraduate degree in Accounting, Finance, Economics or similar	50	50
Marketing MSc	GDBA	None	50	50

Please note: English level and academic progression requirements are correct to the best of our knowledge at the time of going to print. In some circumstances these may change throughout the year - please visit www.intostudy.com/gloucestershire for the most up to date information.

* Also available as an undergraduate degree with integrated International Foundation.

† September intake only.

Dates and prices

The cost of your programme may vary depending on factors including the pathway chosen and programme length. The following guide to costs is based on a typical 3-term programme to show the estimated cost of attendance. For specific cost information, please refer online: www.intostudy.com/gloucestershire/courses

Estimated cost of attendance – current academic year 2018-2019				
	Tuition	Books and fees	Insurance	Total
Integrated Programmes	£12,995-£16,550	£360-£535	£357	£13,712-£17,442
Top-up Degree	£14,820-£18,270	£520-£695	£357	£15,697-£19,322
International Foundation (3 term)	£12,995	£360-£535	£357	£13,712-£13,887
International Year One (3 term)	£12,995	£360-£535	£357	£13,712-£13,887
Graduate Diploma (3 term)	£12,995	£360-£535	£357	£13,712-£13,887
Academic English (1 term)	£3,555	£230-£405	£122	£3,907-£4,082

Accommodation prices			
	Park Villas	Park Challinor	Homestay [†]
Academic programmes			
June start	£7,386	£6,827- £7,386	£8,237
September start	£5,738	£5,320- £5,738	£6,422
January start	£4,983	£4,620- £4,983	£5,577
English language courses*			
Academic English	£2,700	£2,502-£2,700	£3,018

Other fees	
Airport pickup	
Birmingham International Airport	From £110
Bristol International Airport	From £110
London Heathrow Airport	From £155
London Gatwick Airport	From £175
Course-related fees	
Enrolment fee**	From £150
Textbooks (3 term academic programme)	From £210

Start month	Term dates
Academic programmes	
July (4 term)	Mon 01 Jul 2019-Fri 05 Jun 2020
September (3 term)	Mon 16 Sep 2019-Fri 05 Jun 2020
September (4 term)	Mon 23 Sep 2019-Fri 21 Aug 2020
January (3 term)	Mon 06 Jan 2020-Fri 21 Aug 2020
January (2 term)	Mon 06 Jan 2020-Fri 26 Jun 2020
Academic English	
August (16 weeks)	Mon 05 Aug 2019-Fri 06 Dec 2019
September (1 term)	Mon 23 Sep 2019-Fri 06 Dec 2019
January (1 term)	Mon 06 Jan 2020-Fri 20 Mar 2020
April (1 term)	Mon 06 Apr 2020-Fri 19 Jun 2020
June (1 term)	Mon 29 Jun 2020-Fri 11 Sep 2020
Pre-sessional English	
June (10 weeks)	Mon 24 Jun 2019-Fri 30 Aug 2019
September (10 weeks)	Mon 23 Sep 2019-Fri 06 Dec 2019

Prices shown are for the current academic year 01 September 2018– 31 August 2019 and are for indicative purposes only. All prices are subject to an increase of up to 4%.

* Vacation weeks in between terms are extra and will be charged at the weekly accommodation price.

** Per academic programme, charged upon confirmation. Please see our terms and conditions, which are available at: www.intostudy.com/gloucestershire/terms

† **Note:** if you are under the age of 18 at the start of your course, you must stay in homestay accommodation. Once you have turned 18, you will be eligible to apply for residential accommodation, subject to availability.

 **Apply via your local INTO educational counsellor**

If you would like us to put you in contact with one of our counsellors, please contact us.

 **Apply online**

Complete our online application form: apply.intostudy.com

 **Need some help with your tuition fees?**

Check to see if you're eligible for a scholarship: www.intostudy.com/gloucestershire/scholarships

Discover more online

www.intostudy.com/gloucestershire

Connect with us



Contact us

Enquiries and applications:
ukes@intoglobal.com
or +44 1273 876040

Visit the Centre:
into@glos.ac.uk
or +44 1242 714092

Centre address details:
INTO University of Gloucestershire
Cheltenham
Gloucestershire
GL50 2RH
United Kingdom



Through innovative partnerships with leading universities, we expand opportunities for higher education, ensuring success and transforming the lives of our students and staff.

INTO GIVING

Working across the globe, INTO Giving supports projects that increase access to education and improve the quality of teaching and learning. For more information visit www.into-giving.com

© INTO Gloucestershire LLP, September 2018. Every effort is made to ensure that the information provided in this document is correct at the time of publication. However, from time to time there may be occasions where some of the information has changed since the date of publication. The most up to date information can be found on our website at www.intostudy.com/gloucestershire – please refer to this before submitting your application. If, in our opinion, we consider that any change has been made which has a material impact on any offer that has been made to you to study with us we will inform you of these changes in writing. The information provided in this document is subject to INTO Gloucestershire's terms and conditions which can be accessed at www.intostudy.com/gloucestershire/terms

INTO Gloucestershire LLP, registered number OC382463. Registered office: One Gloucester Place, Brighton, East Sussex, BN1 4AA, UK.

Education provider sponsor number 8DHV1QR87

